

Arbeitsaufträge / Krimi-Wortschatz

Auf dieser Seite finden Sie die Auflistung und Übersetzung der im Buch verwendeten Arbeitsaufträge und deren Übersetzungen.

Sinnvoll wäre es, diese groß zu kopieren und im Klassenzimmer aufzuhängen. Das spart Ihnen bei neuen Aufgabenstellungen viel Erklärungszeit, da die Kinder selbst nachschauen können.

Colour...	=	Male ... an.
Describe...	=	Beschreibe ...
Draw...	=	Zeichne ...
Draw lines.	=	Verbinde.
Fill in the right words.	=	Schreibe die richtigen Wörter hinein.
Find out...	=	Finde ... heraus.
Look at...	=	Schau ... an.
Look for...	=	Suche ...
Paint...	=	Male ...
Play with a partner.	=	Spiele zusammen mit einem Partner.
Read...	=	Lies ...
Tick...	=	Hake ab ...
Use...	=	Verwende ...
Write down...	=	Schreibe ... auf.
Write sentences.	=	Schreibe Sätze.

thief = Dieb – thieves = Diebe

criminal = Verbrecher

burglary = Einbruch

steal – stole – stolen = stehlen



Name:

Datum:

Planning a burglary

A thief wants to steal things in the house.
Draw lines.

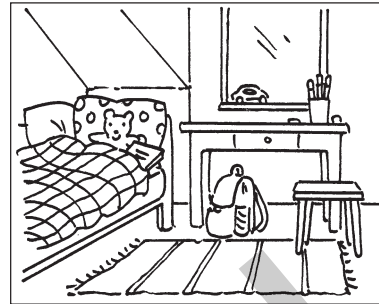
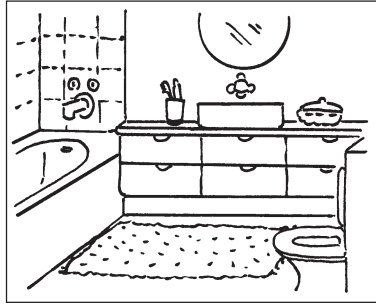

sofa

alarm clock

toilet

school bag

bottle

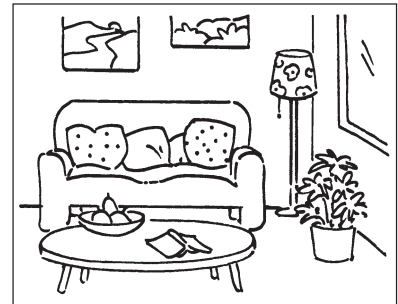
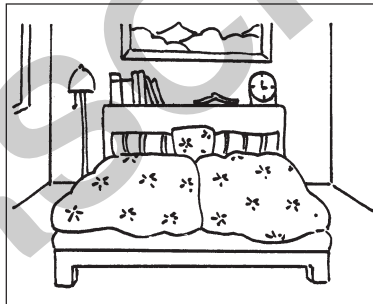
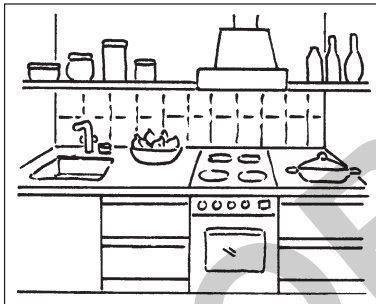

Write sentences.

The sofa is in the living room.

planning a burglary = einen Einbruch planen
wants to = will



Name:

Datum:

Where is the thief?



Colour the thief in every room and in the garden.

Write sentences.

In the hall the thief is under the stairs.

every = jeder, jeden, jede



Name:

Datum:

Where is the money?



Colour the money in every room and in the garden.

Write sentences.

In the hall the money is under the carpet.

money = Geld
 every = jeder, jeden, jede





Name:

Datum:

A thief at breakfast

There is a yummy breakfast on the table.

A hungry thief comes and steals food.

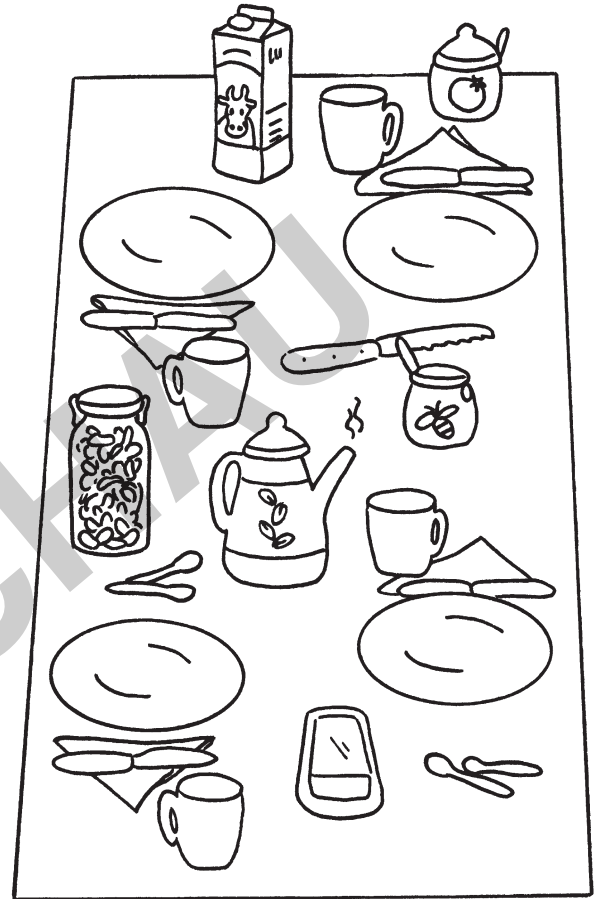
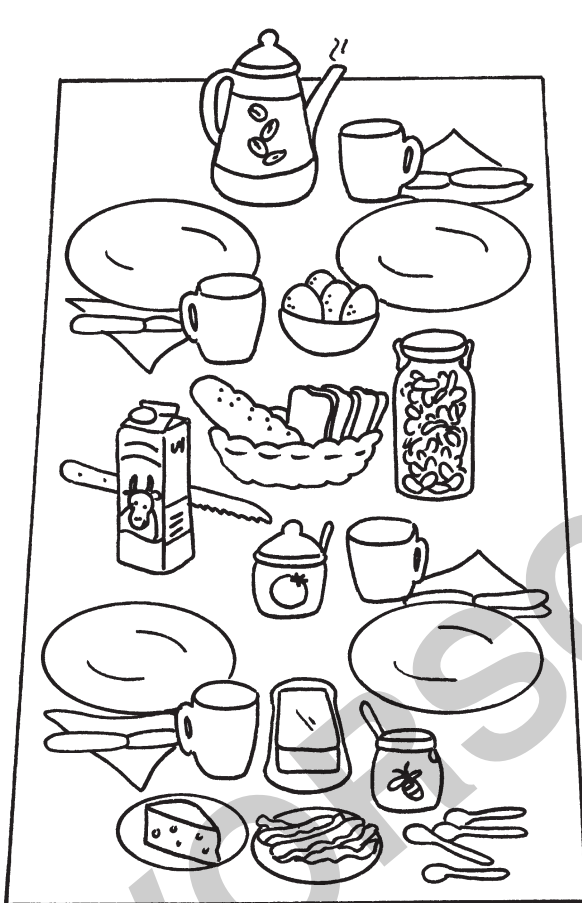

What is missing?

Paint the things on the table.

yummy = lecker
hungry = hungrig
What is missing? = Was fehlt?



Name:

Datum:

Where is the thief?

The thief is on the run.

Go straight on to the supermarket. Turn right. Go straight on to the playground. Turn left. Go straight on to the hospital. Turn right. Turn left. Where is he?



Florida St.

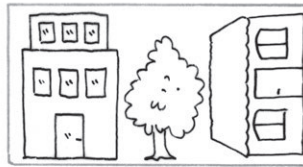

Texas St.

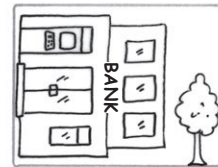

Montana St.



America St.

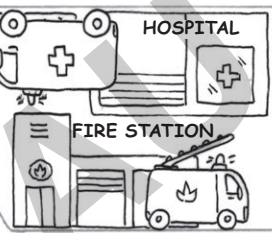
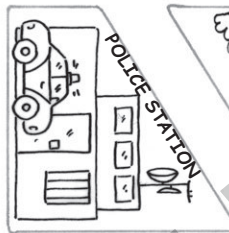

Arizona St.



Nevada St.

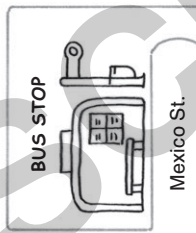

Mexico St.

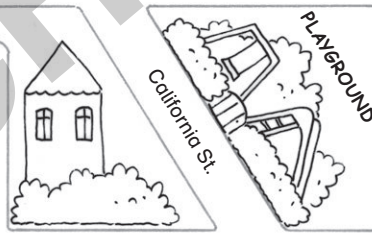

California St.

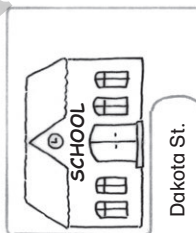

Dakota St.

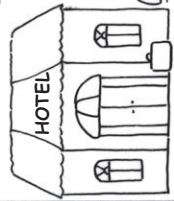
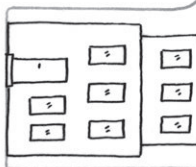
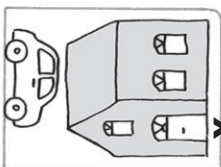
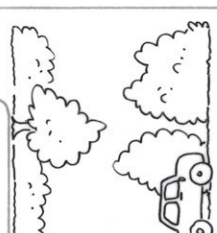

Virginia St.



Play with a partner. You can take a . Describe a route. Where is the thief?

- The thief is on the run. = Der Dieb ist auf der Flucht.
- straight on = geradeaus
- turn left/right = gehe nach links/rechts
- route = Strecke